

naomi j ryan
estate agents



Flat



Bedrooms: 1



Bathrooms: 1



Receptions: 1



Heating: Type here



Parking: On Road



Garden: Yes



Council Tax Band: B

£675



Corn Mill Crescent,

Alphington, Exeter, EX2 8TP

www.naomijryan.co.uk

GROUND FLOOR

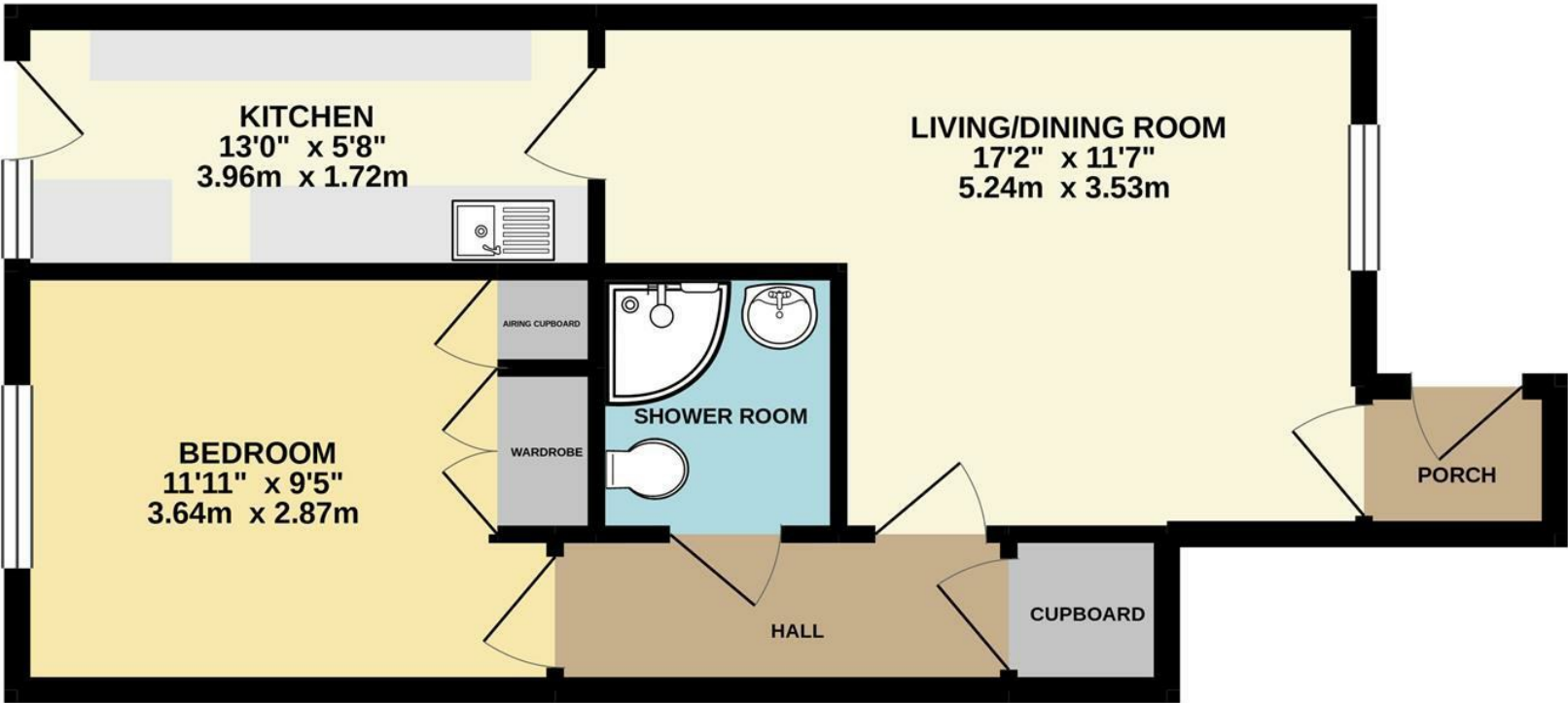

Whilst every attempt has been made to ensure the accuracy of the floorplan contained here, measurements of doors, windows, rooms and any other items are approximate and no responsibility is taken for any error, omission or mis-statement. This plan is for illustrative purposes only and should be used as such by any prospective purchaser. The services, systems and appliances shown have not been tested and no guarantee as to their operability or efficiency can be given.
Made with Metropix ©2021

SUMMARY

****NOW FULLY BOOKED FOR VIEWINGS**** This one double bedroom ground floor flat is available with immediate effect.

Part furnished and well presented throughout the property also has the benefit of gas central heating, a small garden and comes with some items of furniture and all white goods.

The property is available initially for a 6 month term with the possibility of being extended. It would suit a professional person or couple.

Apologies we are unable to consider pets, smokers or children.

EPC Rating D.



naomi j ryan
estate agents





THINKING OF LETTING?

Get in touch for a free,
no obligation valuation.
Call 01392 215283
or email
lettings@naomijryan.co.uk

Energy Efficiency Rating		
	Current	Potential
Very energy efficient - lower running costs		
(92 plus) A		82
(81-91) B		
(69-80) C	67	
(55-68) D		
(39-54) E		
(21-38) F		
(1-20) G		
Not energy efficient - higher running costs		
England & Wales EU Directive 2002/91/EC		
Environmental Impact (CO ₂) Rating		
	Current	Potential
Very environmentally friendly - lower CO ₂ emissions		
(92 plus) A		
(81-91) B		
(69-80) C		
(55-68) D		
(39-54) E		
(21-38) F		
(1-20) G		
Not environmentally friendly - higher CO ₂ emissions		
England & Wales EU Directive 2002/91/EC		

naomi j ryan
estate agents



IMPORTANT: we would like to inform prospective purchasers that these sales particulars have been prepared as a general guide only. A detailed survey has not been carried out, nor the services, appliances and fittings tested. Room sizes should not be relied upon for furnishing purposes and are approximate. If floor plans are included they are for guidance only and illustration purposes only and may not be to scale. If there are any important matters likely to affect your decision to buy, please contact us before viewing the property.

18 southernhay west, exeter, ex1 1pj
t&f . 01392 215283
e . enquiries@naomijryan.co.uk
www.naomijryan.co.uk
company registration number 6693899